

# Type B

## Vertical DPC Cavitrays for introduction into existing masonry skins

- Introduces vertical DPC element
- Suitable for traditional or timber frame construction
- Requires minimal masonry slot cutting to install
- Ensures regulation compliance when using profiles
- Shape suitable for mid-cavity and frame edge positioning



Vertical DPC Cavitrays for introduction into existing masonry skins

### USE

To introduce a vertical DPC element to an existing exterior skin of a cavity wall where its status changes from exterior to interior by virtue of a porch or similar being attached.

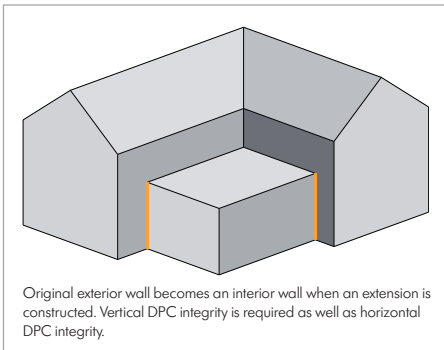

Original exterior wall becomes an interior wall when an extension is constructed. Vertical DPC integrity is required as well as horizontal DPC integrity.

### SOLUTION

The Type B Cavitrays is a semi-rigid vertical DPC that may be introduced into an existing skin following mechanical cutting of the masonry to provide a vertical slot 4-6mm wide. The Type B establishes a permanent DPC presence isolating

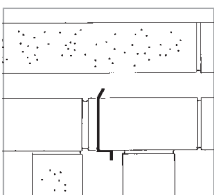

Type B between leaves of cavity wall.

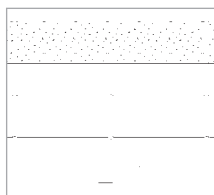

Type B with door-frame

the existing skin externally beyond the vertical point it becomes internal. This product is particularly appropriate where the cavity is not maintained at the point the new porch is attached (no T-junction cavity continuity). This is commonly the status where metal profile links, are secured to the original exterior skin to receive the abutting masonry. Without the Type B inserted adjacent to such profile links dampness can directly permeate inwardly tracking behind the profiles.

### HOW TO ORDER

Standard sizes: state B1, B2 or B3 and number required.

Bespoke sizes: provide dimensions of profile required.

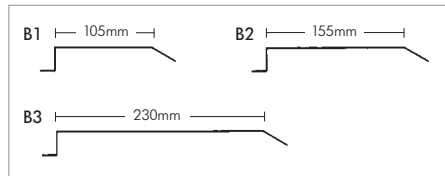

### SPECIFICATION WORDING

Type B Vertical DPC Cavitrays by Cavity Trays of Yeovil Somerset BA22 8HU (01935 474769).

Introduce Type B into pre-cut vertical slot within external skin at attachment junctions.

Metres run measured vertically.....

Request liability/conformity document upon completion.

#### PRODUCT NAME - GROUP

Type B

#### CAVITY WIDTHS ACCOMMODATED

All - width does not affect functionality  
2440mm standard lengths

#### DIMENSIONS

B1 suits up to 105mm masonry skin

B2 suits 150mm thickness skins

B3 suits 225mm thickness skins

#### BESPOKE OPTIONS

Yes

#### TRADITIONAL CONSTRUCTION COMPATIBLE

Yes

#### TIMBER FRAME CONSTRUCTION COMPATIBLE

Yes

#### NEW WORK APPLICATIONS

N/A

#### RETROFIT APPLICATIONS

Yes

#### MASONRY SKIN STYLES

No known limitation

#### UNDULATING MASONRY FACES

Compatible

#### CONGRUENT WITH OTHER WALL ELEMENTS

For use in single storey applications

#### ARRESTED WATER EVACUATION

N/A - no horizontal arrestment

#### THERMAL TRANSMISSION OF MATERIAL

Negligible - 0.15 - 0.17

#### MATERIAL

Polypropylene DPC

#### COLOUR

Black

#### EXTRUDES / COMPRESSES UNDER LOAD

No

#### PACK SIZE

Available individually

#### CFC

CFC Free

#### ODP

Zero

#### REGULATION COMPLIANCE

Can be used to satisfy arrestment

#### MAY BE USED IF CAVITY INSULATION PRESENT?

Yes with compliant insulation types

#### CAD DOWNLOADS

No

#### DESIGN CONSIDERATIONS

Available with optional insulation bonded to one surface to introduce thermal separation. Requires wider cut of masonry.

For horizontal arrestment see Type E Cavitrays.



### DESIGNERS' COMMENTS

Water soaking into masonry does not discriminate and tracks in all directions. The Building Research Establishment states: 'ensure building attachment vertical DPC is provided'.

The Type B Cavitrays cannot act as a continuous cavity at a T junction where a building attaches but it can replicate functionality in preventing wet transmission.