

Type GBFICS

Ground Bearing Floor Insulating Cavity System

- Multi-functional one placement product
- Radon and methane cavity barrier
- Enhanced perimeter insulation

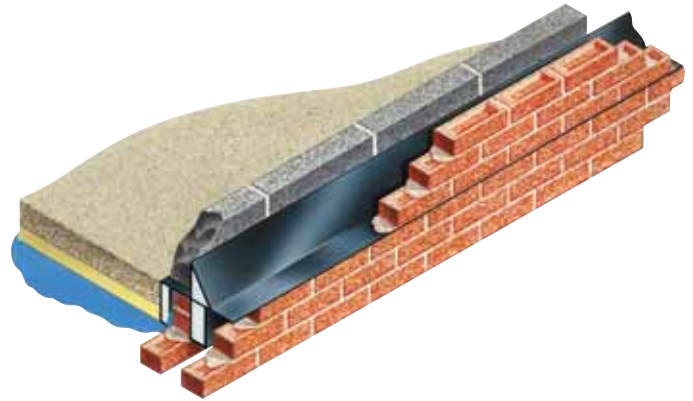

USE

To provide exterior wall ground floor DPC protection around the base of a building in a manner that prevents radon/methane gas entering the cavity and also insulates the arrangement.

SOLUTION

When installed around the perimeter of a building at ground floor level the requirements of Robust Details can be satisfied with use of the Type GBFICS. Manufactured from profiled semi-rigid damp course the Type GBFICS provides the horizontal DPC requirement to both inner and outer skins of the cavity wall. At the same time the cavity is capped, establishing an integral barrier to guard against radon and methane gas rising upwardly via the cavity and permeating the building envelope. To maintain gas tight integrity, the inboard section of the Type GBFICS extends sufficiently to link with a gas-grade oversite membrane. The downward projecting section of the Type GBFICS protects the membrane from damage where it rises against the inner leaf.

Water arrested on the Type GBFICS upper surface is evacuated out of the structure via Caviweeps. Gas rising in the cavity under the

Type GBFICS is evacuated out of the structure via ventilating Cavi bricks appropriately spaced around the building. The integral insulation bonded to the units promotes thermal barrier presence to the slab/inner wall junction and within the cavity.

The Type GBFICS is supplied in long lengths with preformed sections to accommodate corners, threshold openings and changes of level. Units are bedded in mortar after which a sealing strip is applied to unite sections.

The GBFICS is supplied on a bespoke basis to suit the individual project. All profile dimensions are variable. Project evaluations and schedules prepared on request.

HOW TO ORDER

Provide drawing / dimensions and we will immediately advise.

SPECIFICATION WORDING

Type GBFICS to close base of external wall by Cavity Trays of Yeovil Somerset BA22 8HU (01935 474769)

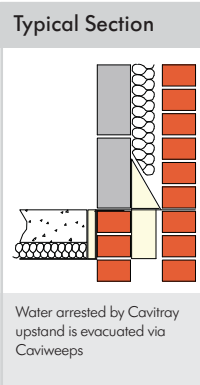

COMPUTER REFERENCE CODES:
CBFICS

PRODUCT NAME - GROUP

Type GBFICS

CAVITY WIDTHS ACCOMMODATED

From 50mm up to 150mm

DIMENSIONS

All variable

BESPOKE OPTIONS

Yes

TRADITIONAL CONSTRUCTION COMPATIBLE

Yes

TIMBER FRAME CONSTRUCTION COMPATIBLE

Yes

NEW WORK APPLICATIONS

Yes

RETROFIT / REMEDIAL APPLICATIONS

No

CURVED WALL ON PLAN APPLICATIONS

Yes some styles possible

CONGRUENT WITH OTHER WALL ELEMENTS

No identified incompatibility

'K' VALUE OF INSULATION USED

0.038W/mK

TYPICAL COMPOSITE THERMAL RESISTANCE

2.63 m²K/W / 100mm cavity

MATERIAL – TRAY

Petheleyne DPC

MATERIAL – INSULATOR

Polystyrene

COLOUR

Black

EXTRUDES / COMPRESSES UNDER LOAD

No

PACK SIZE

No minimum

CFC

CFC Free

ODP

Zero

REGULATION COMPLIANCE

Yes can be used to satisfy arrestment

MAY BE USED IF CAVITY INSULATION PRESENT?

Does not affect functionality

CAD DOWNLOADS

Yes

DESIGNERS' COMMENTS

When used on contaminated ground, the Type GBFICS permits compliance of radon and methane protection requirements to be established and at the same time the thermal insulation standards to be maximised in one product placing.