

Cavi60

Type SAF Horizontal Barrier / Stop

- Acoustic barrier
- Fire barrier
- Protective shape prevents water tracking
- Easy linking and lapping

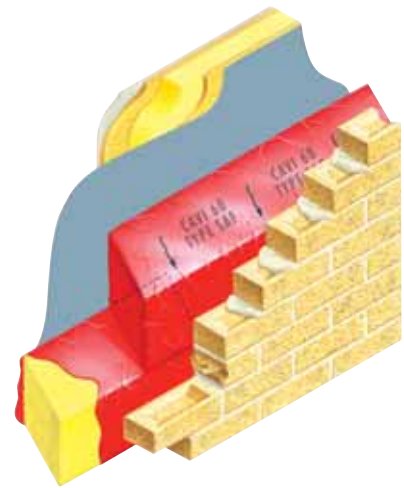

CLOSERS

SOLUTION

This compressible acoustic and fire cavity barrier has sloping upper and lower surfaces that ensure penetrating water is deflected forward. Considered the most cost-effective way of establishing all three qualities within the cavity wall. Sloping shape means integrity can be maintained whenever lengths are lapped.

Optional hard cap DPC cavitray ensures maximum protection. The compliant oriented shape is simply compressed and positioned into cured masonry. Placement can be without tray if appropriate (such as shown in some Robust Details) Alternatively an optional cavitray caps over the upper sloping surface.

Compatible with Type SAF Vertical Barrier, permitting damp protection, fire-stopping and acoustic integrity to be maintained at horizontal and vertical intersections.

REFERENCES

- BS 476 (fire resistance testing)
- Part E details – resistance to the passage of sound
- Building Regulations Document C L1 & L2
- Scottish Tech Standards Part D
- Robust Details

SPECIFICATION WORDING

Cavi 60 Type SAF Horizontal Barrier / Stop by Cavity Trays of Yeovil Somerset BA22 8HU (01935 474769) to suit cavity width of ____mm.

Compress and friction fit within cavity, taking advantage of naturally occurring wall ties as appropriate.

Overlap adjoining lengths to maintain protection integrity to appropriate inner leaf course. Link adjoining lengths to maintain acoustic and fire integrity. Fit optional hard cap tray if required.

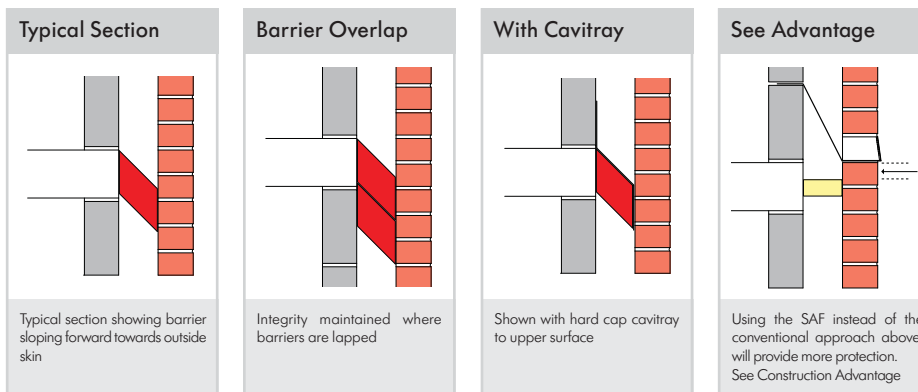

COMPUTER REFERENCE CODES:
CAVI 60 SAF STOP

DESIGNERS' COMMENTS

Use of the Cavi 60 Type SAF Horizontal Barrier / Stop eliminates areas of unprotected masonry between DPC and stop, identified within Robust Detail E-FC-3 (external flanking wall junction). Every building that is divided into more than one area of different occupation must be designed and constructed in such a way that in the event of an outbreak of fire within the building, fire and smoke are inhibited from spreading beyond the area of occupation where the fire originated. 2.2 BR(S) – mandatory

PRODUCT NAME - GROUP

Cavi 60 Type SAF Stop

EXPOSURE RATING

Very severe

CAVITY - STANDARD SIZES ACCOMMODATED

100mm

SPECIAL CAVITY WIDTHS ACCOMMODATED

Yes - state actual cavity width requirement

COMMON CAVITY WALL APPLICATIONS

Yes - build in profile as illustrated

CORNERS AND LINKS

Angled profile laps whilst maintaining integrity

PRODUCT LENGTHS

1.2m & 2.4m

PROTECTIVE SLEEVING DEFLECTS WATER FORWARD

Yes – at all times even where lapped

ACTS AS INSULATOR

Yes insulates entire cavity width – see below

INSTALLED AS WALL IS RAISED

Yes – compresses for optimum fit in cured masonry

TIMBER FRAME / TRADITIONAL CONSTRUCTION

Both styles accommodated

MASONRY SKIN STYLES

Accommodate most types of masonry finish

ACOUSTIC INSULATOR

Yes – reduces direct and flanking transmission

FIRE RATED

Yes Cavi 60 prefix denotes 60 mins (1 hr) rating

HORIZONTAL AND VERTICAL APPLICATIONS

Yes – horizontal and numerous vertical uses

COMPATIBLE WITH OTHER CAVITY WALL ELEMENTS

Yes subject to masonry finishes being appropriate

SECURING TIES SUPPLIED

N/A. Friction fit + naturally occurring ties support

PACK SIZES

Packs contain 10 lengths

THERMAL RESISTANCE PATH

Exceeds minimum requirement

WEIGHT PER PACK

10 kg

COLOUR

Red

BUILDING REGULATIONS

Yes permits regulations to be satisfied

NHBC

Yes permits requirements to be satisfied

'K' VALUE OF INSULATION USED

0.035W/mK

CFC FREE

Yes + zero ODP

CAD DRAWING DOWNLOADS AVAILABLE

Yes

