

# Type C

## Preformed DPC Cavitrays for use with lintels over openings in cavity walls

- Ready-shaped DPC trays for all lintel styles
- Wastage and inaccurate site fabrication eliminated
- Ensures consistent build details and regulation compliance
- Unobstructed cavity compartment area
- Traditional or timber frame construction
- Accurate cost and stock control

### USE

To ensure openings in cavity walls are adequately protected against damp penetration and appropriately shaped to harmonise with whatever style of lintel is deployed. To ensure the compatibility of the horizontal protection with any adjacent vertical closing.

### SOLUTION

Type C Cavitrays are preformed horizontal DPC trays designed to be used with all styles of lintel. Trays provide harmonising yet independent protection against damp. Each tray is manufactured from solid DPC material and is so shaped to suit the lintel styles and lintel arrangements over the opening.

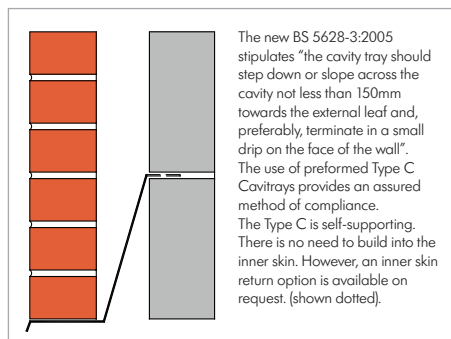

Being preformed eliminates the danger of misplacement, sagging and installation deviances associated with conventional roll material. It also means every opening is uniformly addressed, with assured functionality. The necessity to cut and fabricate on site is eliminated, as is the associated wastage. Type C Cavitrays can be scheduled alongside the lintel schedule, making purchasing and stock control easy.

The shape and dimensions in which Type C Cavitrays are available is almost unlimited. In addition to the range of popular profiles shown,

a bespoke service operates. Thus the profile, profile dimensions and cavity width to be serviced can be selected. Examples are given on subsequent pages.

In addition to the shape options, the specifier may select whether the top of the tray returns into the inner skin or terminates against it. Traditionally DPCs have required building-in for support. However, an added advantage of using a robust semi-rigid preformed tray is that it supports itself and maintains profile (tray is tensioned against the inner skin). The specifier may select which option is preferred. Cavity Trays can advise the most appropriate style to suit construction and regional requirements.

The overall length of each tray exceeds the opening dimension and projects into the masonry either side of the opening. The projection is 300mm each side unless otherwise requested. The purpose of this is to ensure any vertical reveal closing arrangement under is adequately oversailed and protected. Where our Cavi Closers are used to vertically close the reveal, our performance warranty embraces both aspects – horizontal and vertical.

Available to order with Type C Cavitrays are Type L Stopends. These have an integral butyl base that secure the Stopend in position on the tray to coincide with the nearest perp joint towards the tray end. Type L Stopends prevent the water arrested by the tray from discharging into the cavity. Instead the arrested water is evacuated out of the masonry via Caviweeps. It is usual to incorporate a minimum of two\* Caviweeps per opening, located within separate perp joints. Stopends and Caviweeps never share a perp joint – they are always apart.

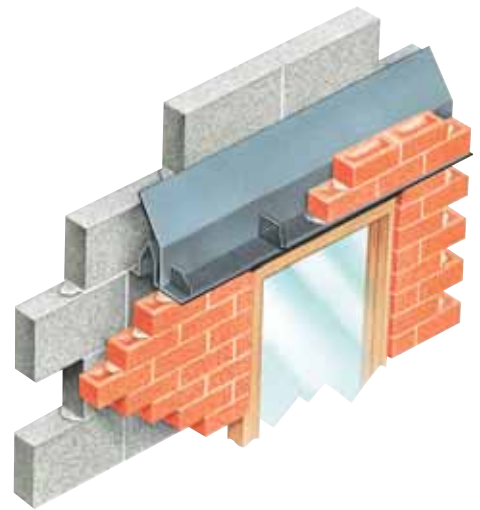

#### PRODUCT NAME - GROUP

Type C

#### CAVITY WIDTHS ACCOMMODATED

From 50mm up to 400mm

#### DIMENSIONS

All dimensions and shapes variable. Popular profiles illustrated

#### BESPOKE OPTIONS

Yes

#### TRADITIONAL CONSTRUCTION COMPATIBLE

Yes

#### TIMBER FRAME CONSTRUCTION COMPATIBLE

Yes

#### NEW WORK APPLICATIONS

Yes

#### RETROFIT APPLICATIONS

See Type E entry

#### MASONRY SKIN STYLES

No known limitation

#### UNDULATING MASONRY FACES

Compatible

#### CURVED WALL ON PLAN APPLICATIONS

Yes – see Curved Wall entries

#### CONGRUENT WITH OTHER WALL ELEMENTS

No identified incompatibility

#### ARRESTED WATER EVACUATION

Via Caviweeps (selection) in perp joints

#### THERMAL TRANSMISSION OF MATERIAL

Negligible - 0.15 – 0.17

#### MATERIAL

Polypropylene DPC

#### COLOUR

Black

#### EXTRUDES / COMPRESSES UNDER LOAD

No

#### PACK SIZE

No minimum

#### CFC

CFC Free

#### ODP

Zero

#### REGULATION COMPLIANCE

Yes can be used to satisfy arrestment

#### MAY BE USED IF CAVITY INSULATION PRESENT?

Functionality not affected

#### CAD DOWNLOADS

Yes

#### DESIGN CONSIDERATIONS

Lip projections to opening only with set back over-sailing to ends available as no-cost option



### DESIGNERS' COMMENTS

NHBC Standards 2010 (External Masonry Walls 6.1 D6 b) states a tray should provide drip protection to door and window heads. Uniformity and consistency of such a requirement can be difficult to achieve using soft roll DPC but with a preformed Type C Cavitrays the angle and dimensions of any lip can be specified and maintained.

# Type C (continued)

## Preformed DPC Cavitrays for use with lintels over openings in cavity walls

- Ready-shaped DPC trays for all lintel styles
- Wastage and inaccurate site fabrication eliminated
- Ensures consistent build details and regulation compliance
- Unobstructed cavity compartment area
- Traditional or timber frame construction
- Accurate cost and stock control

The specifier may choose from a range of compatible Caviweeps offered in different colours, designs and sizes to harmonise with the external masonry and mortar finish. \*See Caviweep pages for guidance on additional Caviweeps on very wide openings or situations where the amount of masonry rising above an opening is extensive – ie: large water absorption area.

### BUILDING IN

Bed tray in illustrated position, do not dry bed. Ensure the tray upstand takes up its intended position terminating against or within the inner skin (pending option selected). Apply Type L Stopends coinciding with perp joint nearest each tray end. Incorporate a minimum of two Caviweeps per tray.

### HOW TO ORDER

Select a popular profile or provide dimensions or drawings to permit us to match your requirements with an appropriate design.

### SPECIFICATION WORDING

Type C Cavitrays to all lintels by Cavity Trays of Yeovil Somerset BA22 8HU (01935 474769). Incorporate to all openings.

Measured run in metres or state number of openings and widths.

Type L Stopends x .....number

Type.....Caviweeps x.....number

Request liability/conformity document upon completion.

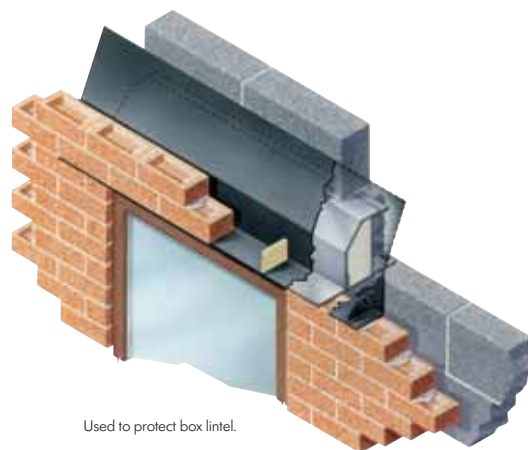

Used to protect box lintel.



To satisfy the aesthetic demands of the area, traditional timber was required over the openings of all the external elevations of this property constructed in cavity masonry. The timber however was not capable of providing the requisite load bearing qualities. Support is provided by a steel lintel immediately above the timber, which extends 150mm past each end of the timber. Thus the timber is not subjected to any load bearing demands. A Type C Cavitrays protects the lower-level timber, in anticipation it might be susceptible to water ingress in the long term following timber shrinkage and settlement. A higher level Cavitrays protects the lintel.



Without an accompanying protective tray this lintel installation fails to comply with UK Building Regulations and European Standards. Protection rising 150mm within the cavity is required. It should also overhang the lintel ends sufficiently to provide shelter to the reveal closing arrangement and ideally accommodate stopend and weep discharge provision. Note the block work inner skin does not offer an ideal course in which to support conventional (floppy) DPC. Consequently more material is required. In contrast, preformed Type C Cavitrays overcome such problems. Type C trays are ready-shaped and supplied in lengths to harmonise with the lintel schedule. Type C Cavitrays are also self-supporting. Compatible stopends and weeps form part of the compliant answer for all common openings in cavity walls.

#### PRODUCT NAME - GROUP

Type C

#### CAVITY WIDTHS ACCOMMODATED

From 50mm up to 400mm

#### DIMENSIONS

All dimensions and shapes variable. Popular profiles illustrated

#### BESPOKE OPTIONS

Yes

#### TRADITIONAL CONSTRUCTION COMPATIBLE

Yes

#### TIMBER FRAME CONSTRUCTION COMPATIBLE

Yes

#### NEW WORK APPLICATIONS

Yes

#### RETROFIT APPLICATIONS

See Type E entry

#### MASONRY SKIN STYLES

No known limitation

#### UNDULATING MASONRY FACES

Compatible

#### CURVED WALL ON PLAN APPLICATIONS

Yes – see Curved Wall entries

#### CONGRUENT WITH OTHER WALL ELEMENTS

No identified incompatibility

#### ARRESTED WATER EVACUATION

Via Caviweeps (selection) in perp joints

#### THERMAL TRANSMISSION OF MATERIAL

Negligible - 0.15 – 0.17

#### MATERIAL

Polypropylene DPC

#### COLOUR

Black

#### EXTRUDES / COMPRESSES UNDER LOAD

No

#### PACK SIZE

No minimum

#### CFC

CFC Free

#### ODP

Zero

#### REGULATION COMPLIANCE

Yes can be used to satisfy arrestment

#### MAY BE USED IF CAVITY INSULATION PRESENT?

Functionality not affected

#### CAD DOWNLOADS

Yes

#### DESIGN CONSIDERATIONS

Lip projections to opening only with set back over-sailing to ends available as no-cost option



### DESIGNERS' COMMENTS

The European Standard for lintels: BS EN 845.2:2001 qualifies corrosion protection required in any individual application, making reference to "the degree of exposure and climatic conditions." We recommend the use of an accompanying Type C Cavitrays at all times to comply with the new European Standard, which is not specific as to where or when such exposure conditions apply. Specifying of Type C Cavitrays at all times to ensure compliance is accordingly recommended.

# Type C (continued)

## Preformed DPC Cavitrays for use with lintels over openings in cavity walls

- Ready-shaped DPC trays for all lintel styles
- Wastage and inaccurate site fabrication eliminated
- Ensures consistent build details and regulation compliance
- Unobstructed cavity compartment area
- Traditional or timber frame construction
- Accurate cost and stock control

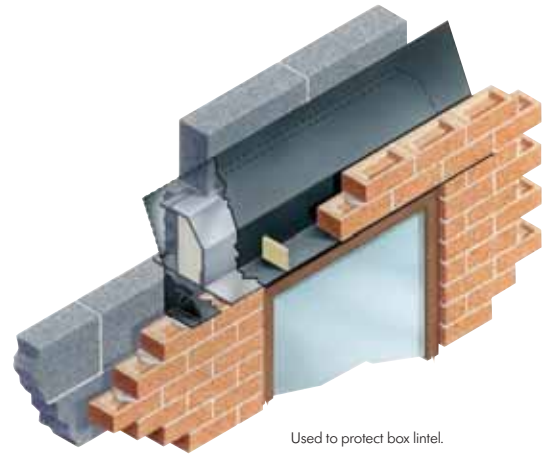

Used to protect box lintel.

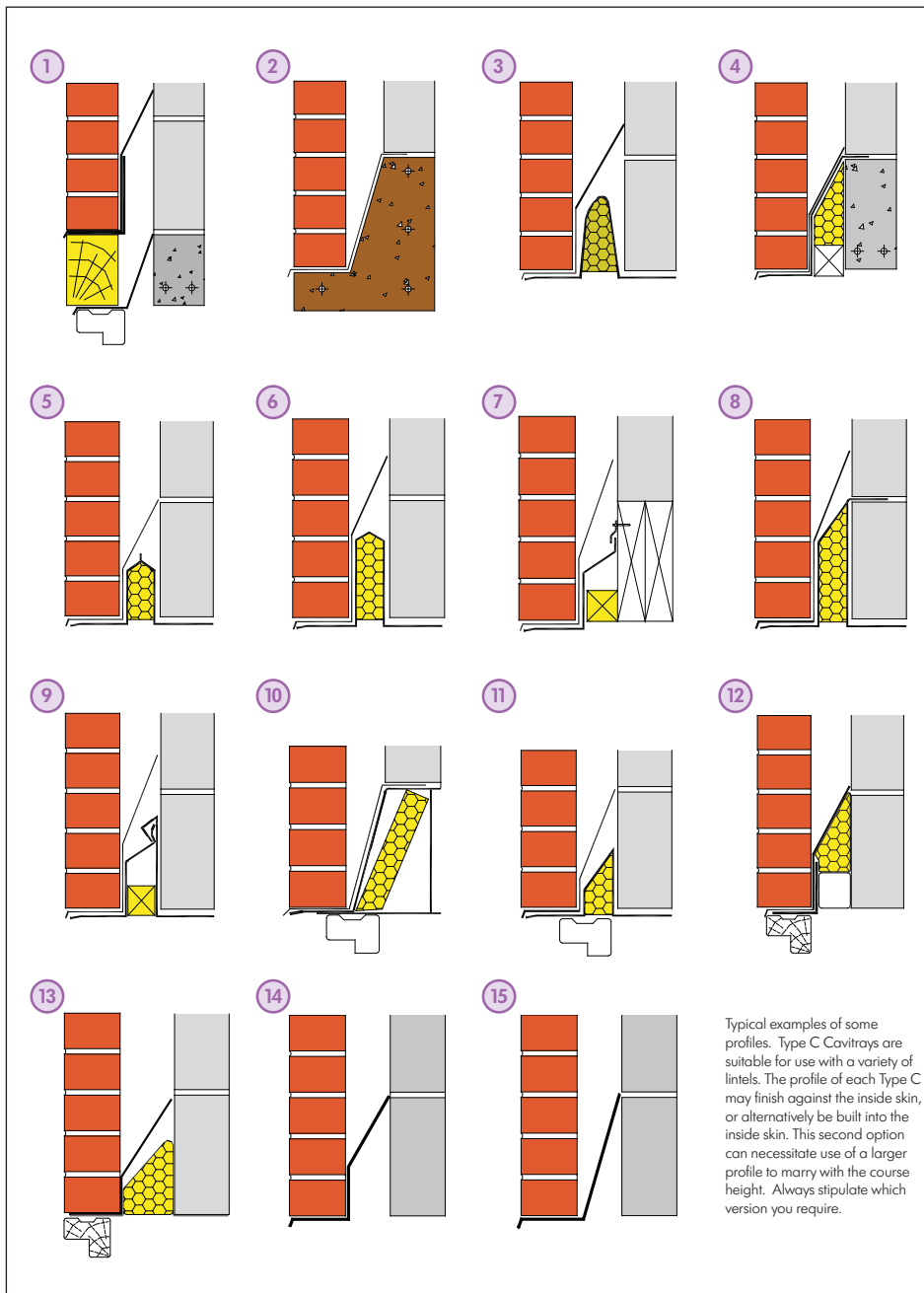

Typical examples of some profiles. Type C Cavitrays are suitable for use with a variety of lintels. The profile of each Type C may finish against the inside skin, or alternatively be built into the inside skin. This second option can necessitate use of a larger profile to marry with the course height. Always stipulate which version you require.

### 3 WAYS TO SELECT THE BEST PROFILE

In accordance with NHBC requirements, a cavity tray should be provided where the cavity is bridged and should extend beyond each side of the bridge. Please provide the following information so the best profile to suit your construction can be identified:

- 1 Send plans and we will calculate all your requirements and prepare a schedule.  
**OR**
- 2 Select one of the standard shapes adjacent and confirm cavity and skin dimensions. State whether trays are to be self-supporting or built-in to the inner skin. Advise opening width, and numbers required.  
**OR**
- 3 Provide dimensions and any appropriate information using the example below as a guide. State whether trays are to be self-supporting or built-in to the inner skin. Whether turn-down lip is required to front of tray.  
Type of lintel  
Opening width + numbers required.  
(Any accompanying drawings are always helpful and can be returned)

A profile confirmation illustration will be sent back to you via e-mail or fax, so you have opportunity to approve before we manufacture.

Use the example profiles adjacent as a guide.

#### DESIGNERS' COMMENTS

There is a general requirement (featured in BS 5628-3:2005) that stipulates the dimension of any tray must step down towards the external leaf not less than 150mm. Any lintel that also acts as a DPC but is under 150mm height does not meet requirement. Be aware and make provision.

