

Cavi60

MWR 200

- One hour fire rated barrier
- Acoustic barrier
- Friction fit
- 100mm to 200mm cavity range

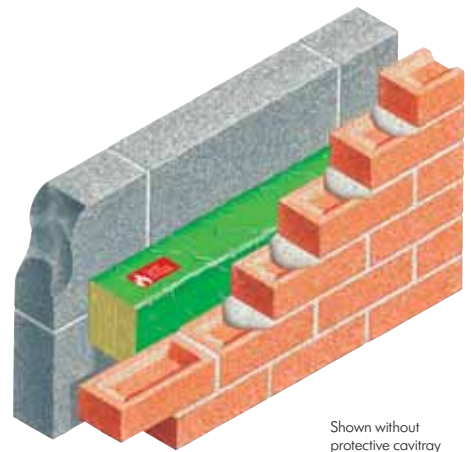

Shown without protective cavitray

SOLUTION

This is a larger version of the Type CFIS and accommodates cavities from 100mm up to 200mm. The Cavi 60 prefix denotes one hours fire rating. The insulating core promotes acoustic suppression. Thus this model can be used to address both fire and sound barrier requirements.

REFERENCES

- BS 476 (fire resistance testing)
- Part E details – resistance to the passage of sound
- Building Regulations Document C L1 & L2
- Scottish Tech Standards Part D
- Robust Details
- British Standard 5628-3
- BRE Thermal Insulation Avoiding Risks

SPECIFY

Cavi 60 MWR 200 Cavicheck Fire Integrity Stop by Cavity Trays of Yeovil Somerset BA22 8HU (01935 474769).

Incorporate within cavity, compressing and placing on naturally occurring ties if appropriate. Cavity width ____mm (stipulate). Specify if optional cavitray protection to suit is required.



Acoustic, Thermal and Fire-Stopping Advantage
Incorporate Cavi 60 MWR barrier or the Cavi 240 CFIS barrier to close the cavity following the roof slope plus the Cavi 240 Type SAF vertical at the exterior wall intersection to satisfy acoustic, thermal and fire-stopping requirements and claim a default value of 0.2.

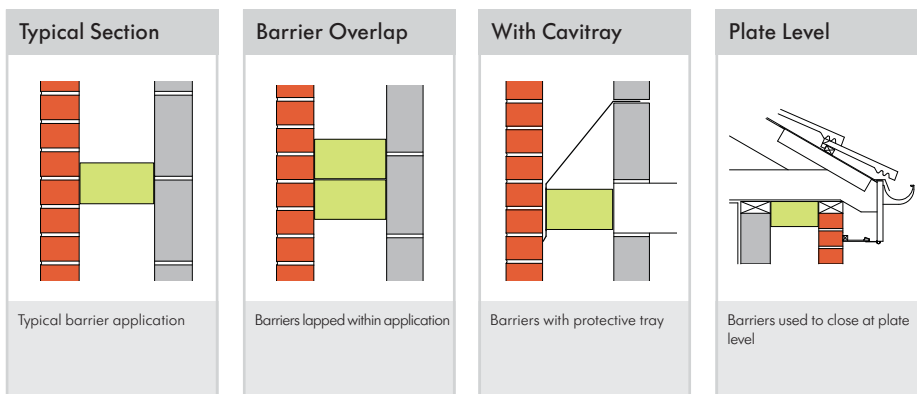

COMPUTER REFERENCE CODES:
CAVI 60 MWR 20

DESIGNERS' COMMENTS

Extensively used at plate level to provide cost effective closing with sound and fire barrier qualities. Establishes one hour fire rated protective separation between cavity and roof space. Every building that is divided into more than one area of different occupation must be designed and constructed in such a way that in the event of an outbreak of fire within the building, fire and smoke are inhibited from spreading beyond the area of occupation where the fire originated. 2.2 BR(S) – mandatory

PRODUCT NAME - GROUP

Cavi 60 MWR 200

EXPOSURE RATING

Very severe

CAVITY - STANDARD SIZES ACCOMMODATED

Up to 100mm up to 200mm maximum

SPECIAL CAVITY WIDTHS ACCOMMODATED

Yes – State actual cavity dimension

COMMON CAVITY WALL APPLICATIONS

Yes – build in cavicheck as illustrated

CORNERS AND LINKS

Lap and butt options

PRODUCT LENGTHS

1.2m

PROTECTIVE SLEEVING

Yes

ACTS AS INSULATOR

Yes – acts as thermal & fire barrier – see below

INSTALLED AS WALL IS RAISED

Yes – compresses for optimum fit in cured masonry

TIMBER FRAME / TRADITIONAL CONSTRUCTION

Both styles accommodated

MASONRY SKIN STYLES

Accommodate most types of finish to either skin

ACOUSTIC INSULATOR

Yes – reduces direct and flanking transmission

FIRE RATED

Yes Prefix denotes 60 mins (1 hr) fire rating

HORIZONTAL AND VERTICAL APPLICATIONS

Yes – horizontal and vertical uses

COMPATIBLE WITH OTHER CAVITY WALL ELEMENTS

Yes – DPC cavitray and caviweep compatible

SECURING TIES SUPPLIED

N/A. Friction fit + naturally occurring traditional ties

PACK SIZES

Packs contain 10 lengths

WEIGHT PER PACK

10kg

MATERIAL

Rock wool insulator within polysleeve

COLOUR

Green

BUILDING REGULATIONS

Yes regulations can be satisfied

NHBC

Yes requirements can be satisfied

'K' VALUE OF INSULATION USED

0.035W/mK

CFC FREE

Yes + zero ODP

CAD DRAWING DOWNLOADS AVAILABLE

Yes

CLOSERS

