

Type M Cavitytray

For use over meter boxes

- Self-supporting upstand adjusts to cavity widths
- Traditional or timber frame construction
- Unobstructed cavity compartment area
- Ensures compliance with guidance standard

USE

To provide protection against damp where a standard meter box impinges the cavity and services enter.

SOLUTION

The Type M Cavitytray provides horizontal protection against damp penetration where a cavity wall accommodates an electricity or gas meter consumer supply unit.

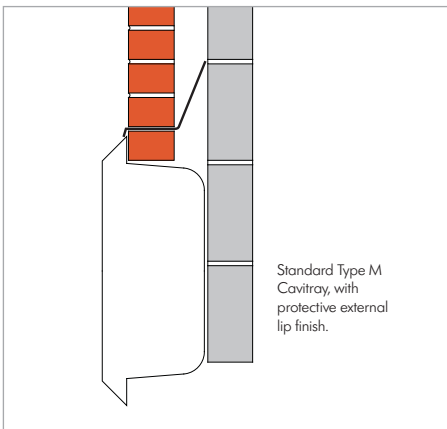

The Type M Cavitytray is manufactured from polypropylene and supplied with a hinged cavity upstand that adjusts to protect the cavity width encountered. Water discharge off the ends of the Type M is prevented by the application of Type L Stopends. Evacuation of water is instead directed through Caviweeps located in perp joints.

The Type M Cavitytray does not require building into the inner skin that therefore remains unpunctured.

HOW TO ORDER

State number and size required.

SPECIFICATION WORDING

Type M Cavitytray over meter boxes by Cavity Trays of Yeovil Somerset BA22 8HU (01935 474769).

Request liability/conformity document upon completion.



Type M Cavitytray for use over meter boxes.

PRODUCT NAME - GROUP

Type M

CAVITY WIDTHS ACCOMMODATED

From 50mm up to 140mm

DIMENSIONS - LENGTHS

600mm or 800mm

BESPOKE OPTIONS

Yes

TRADITIONAL CONSTRUCTION COMPATIBLE

Yes

TIMBER FRAME CONSTRUCTION COMPATIBLE

Yes

NEW WORK APPLICATIONS

Yes

RETROFIT / REMEDIAL APPLICATIONS

See Type E

MASONRY SKIN STYLES

Trays available for all styles

UNDULATING / SPLIT MASONRY FACES

Usually compatible

CURVED WALL ON PLAN APPLICATIONS

Yes – see Curved Wall entries

CONGRUENT WITH OTHER WALL ELEMENTS

No identified incompatibility

ARRESTED WATER EVACUATION

Via Caviweeps (selection) in perp joints

THERMAL TRANSMISSION OF MATERIAL

Negligible

MATERIAL

Polypropylene DPC

COLOUR

Black

EXTRUDES / COMPRESSES UNDER LOAD

No

PACK SIZE / WEIGHT

Individual / 400gms

CFC

CFC Free

ODP

Zero

REGULATION COMPLIANCE

Yes can be used to satisfy arrestment

MAY BE USED IF CAVITY INSULATION PRESENT?

Yes

CAD DOWNLOADS

Yes

DESIGN CONSIDERATIONS

Upstand positioned against inner skin provides optimum protection where cavity insulation is present

DESIGNERS' COMMENTS

NHBC Standards have qualified that where a meter box is not protected by a roof at an appropriate level a DPC tray should be provided. This is supported by BS 5628 and the recently released PD 6697:2010 that qualify cavity wall design should be based on the assumption that water penetrates the outer leaf of the wall, even if it is rendered.

