

Type Y

Stone Mullion Assembly Cavitytray

- Preformed for immediate use
- Packaged per opening
- Consistent detail with regulation compliance
- Different cavity widths accommodated

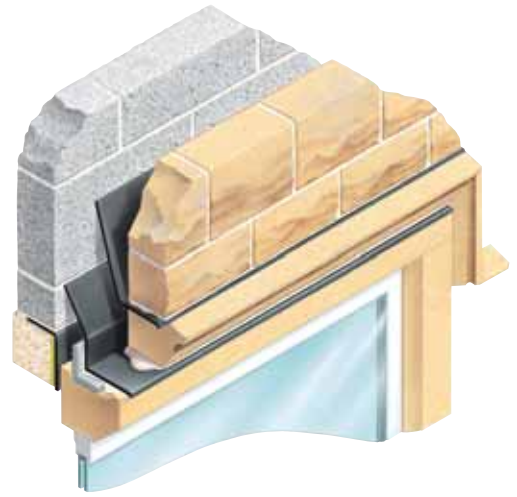

USE

To protect mullion window assembly from damp penetration.

SOLUTION

Manufactured from polypropylene and preformed to shape, a total of three Cavitytrays are required to maintain damp course integrity across the window head of a mullion window assembly.

1. At the highest level bedded on the decorative label-mould (string-course) is the first Cavitytray. Its purpose is to act as an arresting barrier. It receives water from the masonry above and discharges it via Caviweeps positioned at the extended tray ends – well clear of the side mullions.

2. The second Cavitytray is shaped to rest and bed into the supporting metal angle that provides the load bearing qualities to the assembly. There is very little cavity water at this level, the majority having been stopped by the first tray.

3. The third Cavitytray provides a vertical barrier between the lintel on the inside skin and the mullion head. This third tray is commonly supplied with an insulation layer bonded to one surface to minimise thermal transmittance at this point of convergence.

Type Y Cavitytray protection is available to suit all styles of stone and reconstructed stone mullions.

HOW TO ORDER

We will take-off and schedule your requirements and submit for your consideration

SPECIFICATION WORDING

Type Y Cavitytray protection to all mullions by Cavity Trays of Yeovil Somerset BA22 8HU (01935 474769).

Refer to schedule for numbers and sizes.

Request liability/conformity document upon completion.

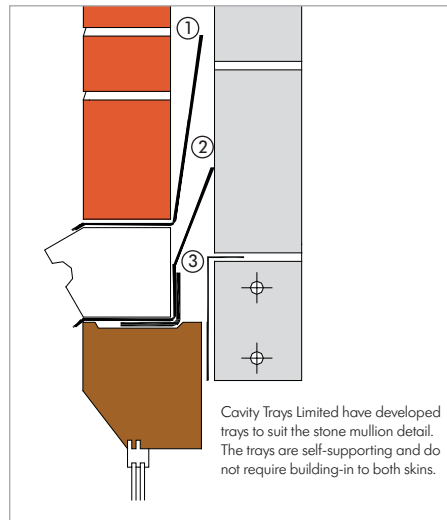

PRODUCT NAME - GROUP

Type Y Stone Mullion Assembly Cavitytray

CAVITY WIDTHS ACCOMMODATED

Up to 150mm

DIMENSIONS

Tray 1 profile 120mm x 200mm

Tray 2 profile 105mm x 110mm

Tray 3 profile 30mm x 125mm

Dimensions vary pending make / style of mullion.

BESPOKE OPTIONS

Yes

TRADITIONAL CONSTRUCTION COMPATIBLE

Yes

TIMBER FRAME CONSTRUCTION COMPATIBLE

Yes

NEW WORK APPLICATIONS

Yes

RETROFIT / REMEDIAL APPLICATIONS

Yes

MASONRY SKIN STYLES

Most regular styles

UNDULATING / SPLIT MASONRY FACES

Normally compatible

CURVED WALL ON PLAN APPLICATIONS

Some bespoke options offered

ARRESTED WATER EVACUATION

Via discreet Caviweeps in perp joints

THERMAL TRANSMISSION OF MATERIAL

Bonded thermal break optional

MATERIAL

Tray Polypropylene DPC

Insulation Phenolic foam class O

COLOUR

Black

EXTRUDES / COMPRESSES UNDER LOAD

No

PACK SIZE

Available individually

CFC

CFC Free

ODP

Zero

REGULATION COMPLIANCE

Yes can be used to satisfy arrestment

MAY BE USED IF CAVITY INSULATION PRESENT?

Does not affect functionality

CAD DOWNLOADS

Yes

DESIGN CONSIDERATIONS

Visual lip recommended as it protects bedding course but some specifiers elect to use a non-lipped version so protection is not evident.



DESIGNERS' COMMENTS

Be aware if using reclaimed mullions. The original BS 6073 made no reference to the maximum water absorption requirements of synthetic stone and consequently standards of manufacture and performance varied considerably. BS 1217 introduced limitations and performance improved. Reclaimed mullions can vary considerably in terms of water absorption and corresponding rates of saturation. Where the amount of masonry rising above a mullion is extensive, always consider the potential water penetration volume gravitating downwardly in the cavity.