

Type H

Cavicloser

- Closes cavity and accommodates a range of cavity widths
- Acts as a DPC
- Insulates and introduces a thermal zone
- Permits choice of frame position
- Frame fixing when work proceeds or at later date
- Integral fins

SOLUTION

The Type H is a two part closer. A separate faceplate is attachable to whichever side of the closer body is selected to suit the cavity width and window position. Accompanying wall ties anchor into the moulded dovetails to permit easy bonding as the masonry is raised.

Anti capillary features provide a check against wind-driven rain.

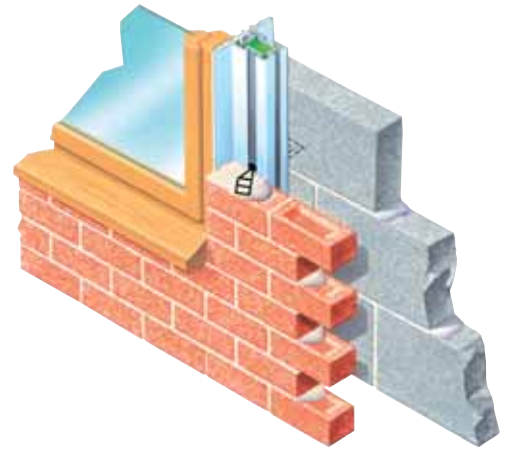

REFERENCES

- Building Regulations Document C L1 & L2
- British Standard 5628-3
- BRE Thermal Insulation Avoiding Risks
- Cavity Trays Ltd main manual
- Website: cavitytraystandards.co.uk
- Robust Details
- Scottish Tech Standards Part D

SPECIFICATION WORDING

Type H1 or H2 (stipulate) by Cavity Trays of Yeovil Somerset BA22 8HU (01935 474769) to close cavity wall reveal. Cavity size: (state width).

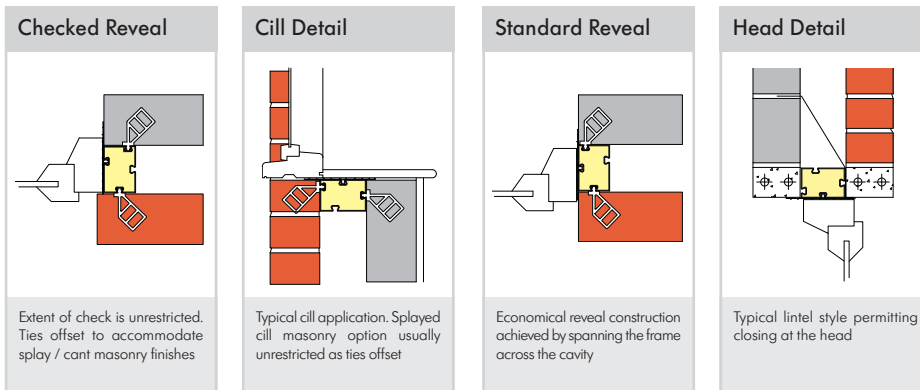

COMPUTER REFERENCE CODES:

H X 2.1M H 2 X 2.1M (H2 LARGER PROFILE)
H X 3.0M H 2 X 3.0M (H2 LARGER PROFILE)

PRODUCT NAME - GROUP

Type H Cavicloser

EXPOSURE RATING / FRAME RELATIONSHIP

Severe 30mm+ setback. Very severe when checked

CAVITY - STANDARD SIZES ACCOMMODATED

70mm & 100mm

SPECIAL CAVITY WIDTHS ACCOMMODATED

No – see alternative models

STRAIGHT REVEALS

Yes – build in profile as supplied

CHECKED REVEALS

Yes – build in as illustrated

PRODUCT LENGTHS

2.1m, 3.0m

ACTS AS VERTICAL DPC

Yes

ACTS AS INSULATOR

Yes

PERMITS DIFFERENT FRAME POSITIONS

Yes

FRAMES FITTED AS WORK PROCEEDS OR LATER

Yes – first or second fix options

TIMBER FRAME / TRADITIONAL CONSTRUCTION

Both styles accommodated

MASONRY SKIN STYLES

All popular flat faced masonry

UNDULATING MASONRY FACE FINISHES

Seek advice providing details of material

FIRE RATED

No (see Cavi prefixed range for fire rated)

VERTICAL AND HORIZONTAL APPLICATIONS

Yes – see examples

COMPATIBLE WITH OTHER CAVITY WALL ELEMENTS

No known restrictions

SECURING TIES SUPPLIED

Yes

PACK SIZES

H x 6 lengths per pack

WEIGHT PER PACK INCLUDING FACEPLATES

H x 2.1 = 24.kg 3m = 35kg.

MATERIAL

PVCU + polystyrene inskorfoam

COLOUR

White

BUILDING REGULATIONS

Yes requirements can be satisfied

NHBC / ROBUST DETAILS

Yes permits requirements to be satisfied

'K' VALUE OF INSULATION SAMPLE

0.038W/mK

POSSIBLE COMPOSITE THERMAL RESISTANCE PATH

1.90 m² K/W (75mm cavity)

CFC FREE

Yes + zero ODP

CAD DRAWING DOWNLOADS AVAILABLE

Yes



DESIGNERS' COMMENTS

Faceplate location in relation to reveal can be varied, benefiting situations where frame is deeply set.