

# Cavi120

## Type V Cavicloser

- 120 minutes fire integrity rating
- Suitable in cavities from 50mm to 100mm wide
- Acts as a DPC
- Closes and insulates reveals
- Anti capillary fins

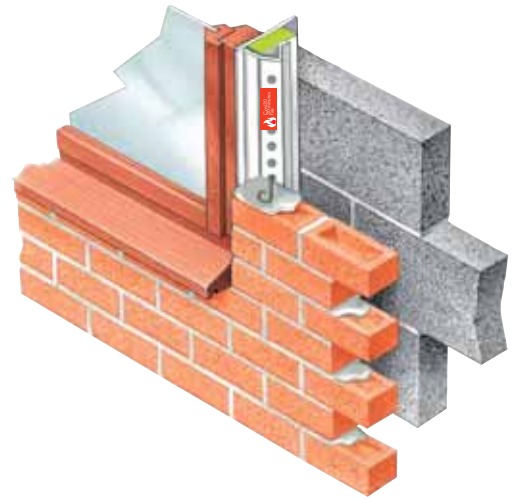

### SOLUTION

The Cavi 120 Type V has a two-hour fire rating, a sound reducing insulator and is available for cavity sizes up to 100mm. This closer may be used in straight reveals but is also suitable for use with checked reveals. Always state clearly which option is required. The checked reveal version does not have a front projecting lip, and terminates against the inside (cavity) face of the outer skin.

### REFERENCES

- BS 476 (fire resistance testing)
- Part E details – resistance to the passage of sound

- Building Regulations Document C L1 & L2
- Scottish Tech Standards Part D
- Robust Details
- British Standard 5628-3
- BRE Thermal Insulation Avoiding Risks

### SPECIFICATION WORDING

Cavi 120 Type V fire rated + acoustic cavicloser by Cavity Trays of Yeovil Somerset BA22 8HU (01935 474769) to close cavity wall reveal.

Cavi 120 Type V to suit \_\_\_\_mm cavity. (enter appropriate cavity width dimensions). State straight or checked reveal.

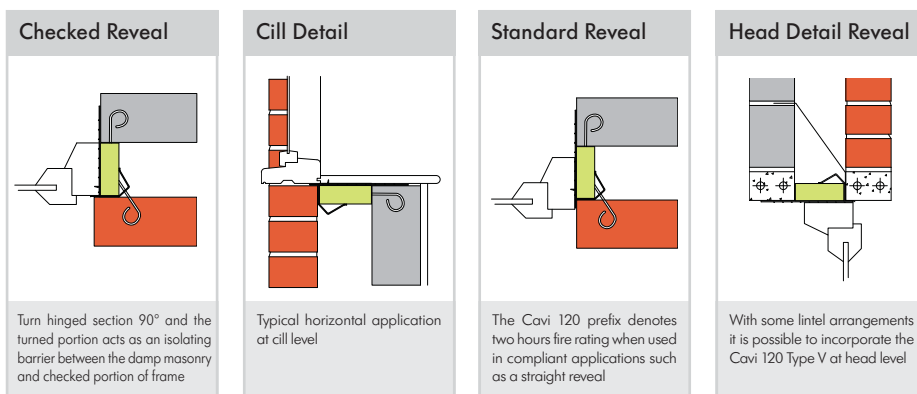

#### COMPUTER REFERENCE CODES:

CAVI 120 V 2.1 50      CAVI 120V 3.0 50  
CAVI 120 V 2.1 75      CAVI 120 V 3.0 75  
CAVI 120 V 2.1 100     CAVI 120 V 3.0 100

#### PRODUCT NAME - GROUP

Cavi 120 Type V Cavicloser

#### EXPOSURE RATING

Severe 30+mm setback. Very severe when checked

#### CAVITY - STANDARD SIZES ACCOMMODATED

50mm, 65mm, 75mm, 85mm, 100mm

#### SPECIAL CAVITY WIDTHS ACCOMMODATED

Yes bespoke closer service offered

#### STRAIGHT REVEALS

Yes – build in profile as supplied

#### CHECKED REVEALS

Yes – request special version

#### PRODUCT LENGTHS

2.1m, 3.0m

#### ACTS AS VERTICAL DPC

Yes

#### ACTS AS INSULATOR

Yes

#### PERMITS DIFFERENT FRAME POSITIONS

Yes

#### FRAMES FITTED AS WORK PROCEEDS OR LATER

Yes – first or second fix options

#### TIMBER FRAME / TRADITIONAL CONSTRUCTION

Both styles accommodated

#### MASONRY SKIN STYLES

All popular flat faced masonry

#### UNDULATING MASONRY FACE FINISHES

Seek advice providing details of material

#### ACOUSTIC INSULATOR

Yes – acoustic transmission reduction

#### FIRE RATED

Yes Prefix denotes 120mins (2hrs) integrity rating

#### VERTICAL AND HORIZONTAL APPLICATIONS

Yes – see examples

#### COMPATIBLE WITH OTHER CAVITY WALL ELEMENTS

No known restrictions

#### SECURING TIES SUPPLIED

Yes

#### PACK SIZES

Packs of 5 or 10 closers, pending length.

#### WEIGHT PER PACK

2.1m x 10 = 19.5kg. 3m x 5 = 14kg.

#### MATERIAL

PVCU + rock fibre insulator + stainless ties

#### COLOUR

White extrusion

#### BUILDING REGULATIONS

Yes regulations can be satisfied

#### NHBC

Yes requirements can be satisfied

#### 'K' VALUE OF INSULATION USED

0.035W/mK

#### CFC FREE

Yes + zero ODP

#### CAD DRAWING DOWNLOADS AVAILABLE

Yes



CLOSERS

### DESIGNERS' COMMENTS

Straight and cranked reveals accommodated. The extent the masonry is offset is not limited. Inclusive of stainless steel ties to secure to both skins. Bespoke options available.