

Cavi240

Type CFIS

- 240 minutes fire integrity rated stops
- Easy friction fit
- Accompanying moisture protection measures
- For cavity widths up to 100mm

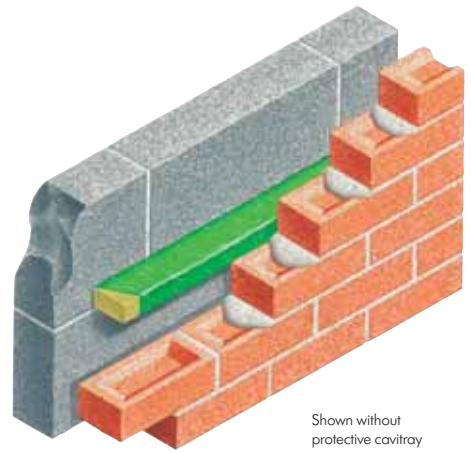

Shown without protective cavitray

SOLUTION

Non-combustible rock mineral insulator promoting acoustic and fire barrier qualities enveloped within a green poly-sleeve. May be compressed to suit cavities of most popular sizes. Preformed trays (Arresting Barriers or Dropcloaks) available to provide deflective qualities within cavity.

REFERENCES

- BS 476 (fire resistance testing)
- Part E details – resistance to the passage of sound
- Building Regulations Document C L1 & L2
- Scottish Tech Standards Part D
- Robust Details
- British Standard 5628-3
- BRE Thermal Insulation Avoiding Risks

SPECIFY

Cavi 240 Type CFIS Cavichex fire integrity stop by Cavity Trays of Yeovil Somerset BA22 8HU (01935 474769).

Incorporate within cavity, compressing and placing on naturally occurring ties if appropriate. Cavity width ____ mm (stipulate). Specify if optional cavitray protection to suit is required.

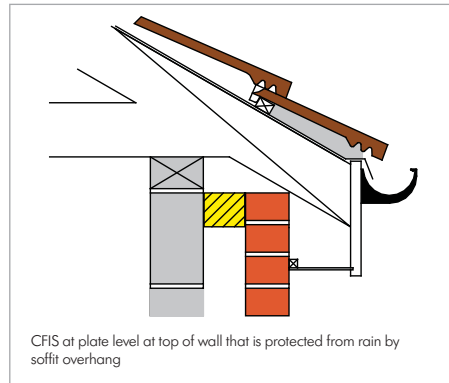

CFIS at plate level at top of wall that is protected from rain by soffit overhang

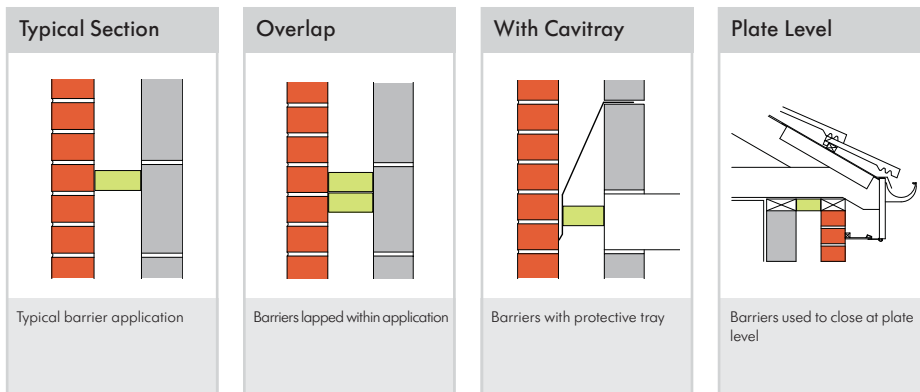

COMPUTER REFERENCE CODES:
CFIS 1.2
CFIS 2.4

PRODUCT NAME - GROUP

Cavi 240 Type CFIS

EXPOSURE RATING

Very severe

CAVITY - STANDARD SIZES ACCOMMODATED

Up to 100mm maximum

SPECIAL CAVITY WIDTHS ACCOMMODATED

Yes – compression fit

COMMON CAVITY WALL APPLICATIONS

Yes – build in cavichex as illustrated

CORNERS AND LINKS

Lap and butt options

PRODUCT LENGTHS

1.2m

PROTECTIVE SLEEVING

Yes

ACTS AS INSULATOR

Yes – provides highest fire rating – see below

INSTALLED AS WALL IS RAISED

Yes – compresses for optimum fit in cured masonry

TIMBER FRAME / TRADITIONAL CONSTRUCTION

Both styles accommodated

MASONRY SKIN STYLES

Compresses to accommodate most skin finishes

ACOUSTIC INSULATOR

Yes – reduces direct and flanking transmission

FIRE RATED

Yes Cavi 240 prefix denotes 240 mins (4 hrs) rating

HORIZONTAL AND VERTICAL APPLICATIONS

Yes – horizontal and vertical uses

COMPATIBLE WITH OTHER CAVITY WALL ELEMENTS

Yes – DPC cavitray and caviweep compatible

SECURING TIES SUPPLIED

N/A - friction fit + any appropriate ties

PACK SIZES

Packs contain 10 lengths

WEIGHT PER PACK

7.5 kg

MATERIAL

Rock wool insulator within polysleeve

COLOUR

Green

BUILDING REGULATIONS

Yes regulations can be satisfied

NHBC

Yes requirements can be satisfied

'K' VALUE OF INSULATION USED

0.035W/mK

CFC FREE

Yes + zero ODP

CAD DRAWING DOWNLOADS AVAILABLE

Yes



DESIGNERS' COMMENTS

The four hour rating is the highest currently achievable in this style of barrier and permits the specifier to introduce a higher level of fire protection rating within the financial restraints normally associated with alternatives with lower ratings.

Every building that is divided into more than one area of different occupation must be designed and constructed in such a way that in the event of an outbreak of fire within the building, fire and smoke are inhibited from spreading beyond the area of occupation where the fire originated. 2.2 BR(S) – mandatory