

# Type RAV-FL

## Roof Abutment Ventilator

- Permits roof to breathe at masonry intersection
- Integral insect screening
- High airflow - 25,000mm<sup>2</sup> per metre run
- Removable when re-roofing

<b>PRODUCT NAME</b>	Type RAV-FL Roof Abutment Ventilator for Flat Roofs
<b>SIZE</b>	200 o/a x 50mm o/a
<b>FREE AIRFLOW RATING</b>	25,000mm <sup>2</sup> per running metre
<b>COLOUR</b>	Light grey (hidden when overdressed with flashing)
<b>MATERIAL</b>	PVCU
<b>OBSERVATIONS</b>	Use where flat roof requires 25mm equivalent gap

### USE

To provide ventilation where flat roofs abut masonry.

### SOLUTION

The RAV-FL promotes air entry where a flat roof abuts a vertical masonry wall. It is supplied with pre-drilled fixing holes and an integral insect-resistant grille. Each unit is 1.2 metres in length and the heavy-duty profile incorporates an integral pivothold hinge. This hinge permits easy and direct fixing, as the profile may be secured to the vertical board upstand when opened like a book.

The profile is then closed and fixing completed by securing the top of the profile to the masonry wall. An air ventilation path which complies with the current regulations is established at the flat roof intersection.

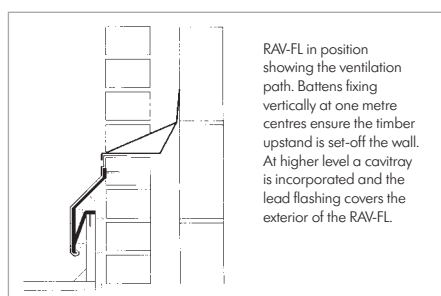

# Type ERV

## External Roof Ventilator

- High free airflow of 6,000mm<sup>2</sup>/12,000mm<sup>2</sup>
- Natural lead finish
- Integral baffles and drain-out slot
- New and existing work applications

<b>PRODUCT NAME</b>	Type ERV External Roof Ventilator
<b>SIZE (2)</b>	210 x 140 x 160mm    405 x 140 x 160mm
<b>FREE AIRFLOW RATING</b>	6,000mm <sup>2</sup> (small)    12,000mm <sup>2</sup> (large)
<b>COLOUR</b>	Natural lead colour
<b>MATERIAL</b>	Lead Flashing BS EN 12588
<b>OBSERVATIONS</b>	Fabricated lead sheet product

### USE

To provide ventilation within flat and low pitched roofs.

### SOLUTION

The Type ERV External Roof Ventilator is designed to permit the roof void to breathe and prevent condensation occurring. Intended for use on lead covered, felted or similarly decked roofs, the Type ERV is manufactured from lead to BS EN 12588:2006.

When positioned on a plinth or raised surface to suit the application and location, the Type ERV can provide a means of exhausting moist air out of the structure.

