

Type RAV-FL

room ventilation packs and gas appliance packs

- Permits roof to breathe at masonry intersection
- Integral insect screening
- High airflow - 25,000mm² per metre run
- Removable when re-roofing

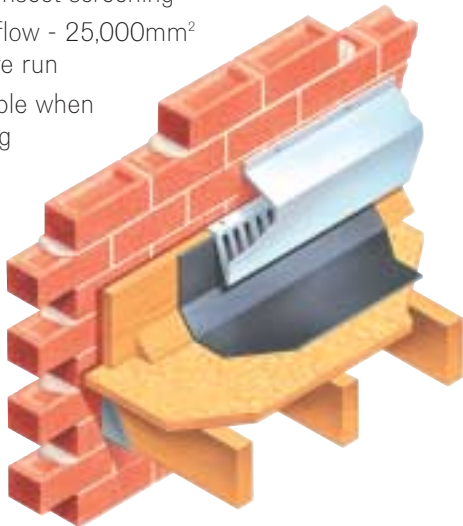

use

To provide ventilation where flat roofs abut masonry.

introduction

The RAV-FL promotes air entry where a flat roof abuts a vertical masonry wall. It is supplied with pre-drilled fixing holes and an integral insect-resistant grille. Each unit is 1.2 metres in length and the heavy-duty profile incorporates an integral pivethold hinge. This hinge permits easy and direct fixing, as the profile may be secured to the vertical board upstand when opened like a book.

The profile is then closed and fixing completed by securing the top of the profile to the masonry wall. An air ventilation path which complies with the current regulations is established at the flat roof intersection. The product is compatible for use with our horizontal intersection cavitytrays which may be established at a higher level to permit the flashing to be dressed down to cover the external shell of the RAV-FL profile.

data

- RAV-FL = 1.2 metres x 200mm o/a x 50mm o/a x 3mm thickness.
- Integral ventilation grille promotes equivalent of a 25mm continuous gap.
- Grade A1 compound PVCU, grey.
- Available individually.

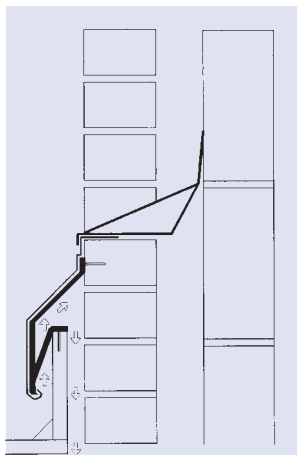

RAV-FL in position showing the ventilation path. Battens fixing vertically at one metre centres ensure the timber upstand is set-off the wall. At higher level a cavitytray is incorporated and the lead flashing covers the exterior of the RAV-FL profile.



Consider for use where shown. See inside cover for key.

Type REV

refurbishment eaves ventilator

- Translucent - checking of correct placement is easy
- Large protected air pocket
- High airflow 10,000mm² per metre run
- Compliance of ventilation regulations

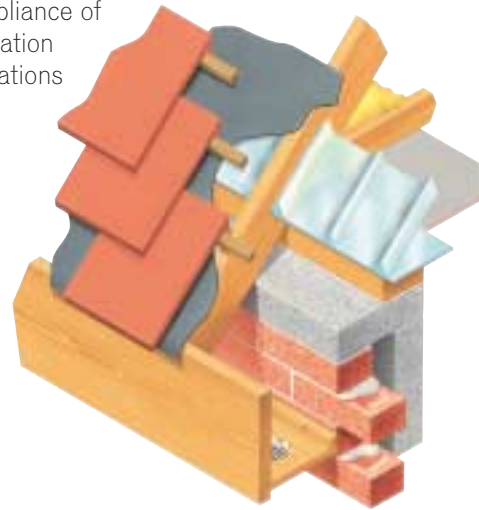

use

Preformed eaves ventilator for introduction between rafters in existing roof spaces.

be used with this refurbishment eaves ventilator.)

data

- PVC, clear or black
- REV600 for 600mm rafter spacing.
- REV400 for 400mm and 450mm rafter spacing.
- Suits numerous truss spacings.
- Excellent free airflow.
- Compatible with other ventilators.
- Delete copy where shown.
- Packed in boxes containing 50no.
- Smaller quantities available.
- Packed in boxes containing 50no.
- Smaller quantities available.

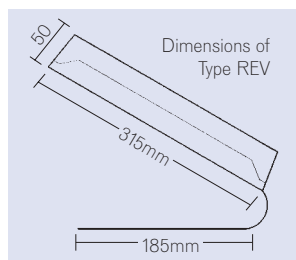

introduction

The refurbishment eaves ventilator fits between rafters and can be placed in position from within the attic space. The ventilator bottom portion rests under the insulation.

The ventilator top hinged portion hinges to follow the roof line. Its simple shape allows air to travel to and from the roof void. Insulation is not permitted to close the gap between the truss rafters. (Note: In existing properties air entry is normally introduced through the existing soffit. Please see CSV circular soffit ventilators which may

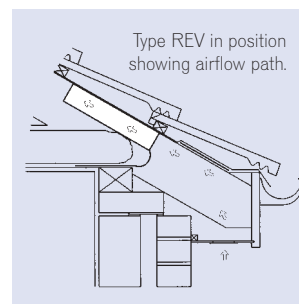

Consider for use where shown. See inside cover for key.