

# Quickcloser

vertical closer with flexible insulating core

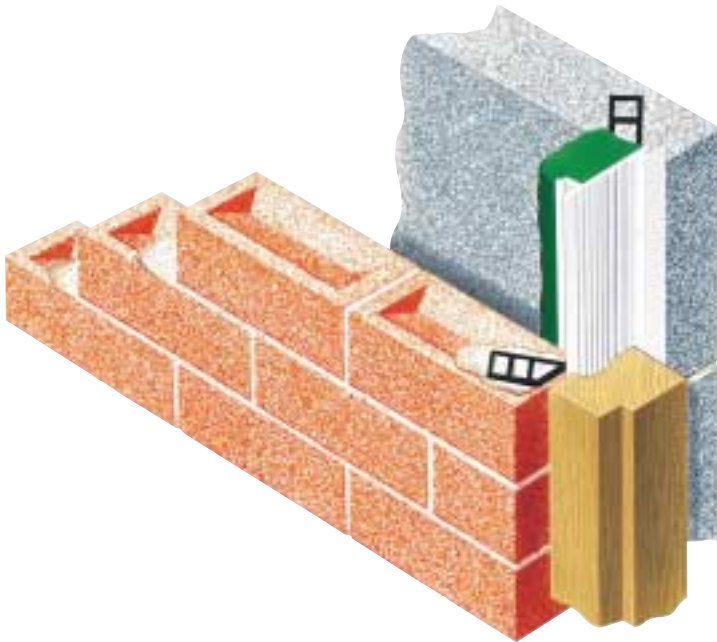

- Closes the reveal
- Insulates cavities from 40mm to 100mm wide
- Acts as a DPC
- New and existing structure applications
- Integral Fins

## problem

How to close and insulate the cavity wall reveal and establish a vertical DPC.

## introduction

The quickcloser provides an alternative method of closing cavity wall reveals in new build construction. It may also be employed to regularise open reveals or reveals uncovered during refurbishment and improvement works. The insulating medium is flexible, and contained within a sleeve that can be squeezed to shape to fill the cavity snugly, eliminating voids. At the same time the quickcloser acts as a DPC, eliminating the need for a conventional vertical damp course.

## solution

The quickcloser is designed for use in cavity walls and will fit cavity widths from 40mm up to 100mm. If

sheet insulation exists in the cavity against the inside skin, the quickcloser can be used to advantage to wrap around and marry with the sheet vertical edge. At no time is cutting required to alter the width of the insulating medium. The quickcloser is ready for use immediately on all conventional straight reveals within the cavity range specified. In the case of the checked reveal, the projecting hinged section to the front of the quickcloser is turned 90 degrees. This instantly creates a checked reveal closer, with the turned section acting as an additional integrity barrier between the 'checked' frame and the oversailing masonry.

## frame positions

Frame positions are not restricted, conditional that the frame is secured in a thermally efficient position in

accordance with regulation requirements.

## building-in

Full instructions accompany all supplies.

Use one closer length for each reveal side and cut bottom off to reduce in height when required. Position the quickcloser as illustrated and secure every 225mm using quickcloser dyadic ties as the cavity wall is raised. Ensure the insulating core takes up shape to fill the reveal void. Always study the full instructions prior to commencing work.

## sizes

Nominal 120mm x 45mm x 21 or 2.4 metres. Packed in 10s with accompanying ties.

## material

PVCU and polythene. Polypropylene ties.

Siliconised RDT semi-rigid waterproof insulating glass.

## colour

White with green sleeve.

## bill of quantity wording

Quickcloser by Cavity Trays of Yeovil, Somerset, BA22 8HU (01935 474769). Incorporate to close reveals when raising cavity walls. Measured vertically ...metres.

## ordering/regulations

See inside back cover for details.

## related products

See Type O for refurbishment/upgrading of existing structures without requirement for structural fixing. See Types H, V and D for new work applications.

## designers' comments

The insulating medium is designed non-combustible (BS 476 class 0). Classified as waterproof (of the style approved performance assessed for cavity full fill and granted an Agreement certificate). This product now has increased insulation within the sleeve and the installer must work shape to maximise a consistent and uninterrupted full fill, to promote performance as is achieved when used as conventional cavity insulator, when a typical listed U value is 0.28 in brick-cavity-block construction, when used with an internal leaf of 100mm block @ 480kg/m<sup>3</sup>. Closers aid thermal efficiency and compliance of regulations is conditional on all associated and adjacent work being constructed to the most beneficial design using materials that promote optimum thermal performance with frames being positioned to provide maximum thermal efficiency in accordance with best practice dimensions and legislation. Facility to swivel profile edge to create a checked reveal closer addresses benefit identified in NHBC masonry walls 61S4(e).

