

## Specifications

Product name - group	Quickcloser
Exposure Rating	Severe
Cavity - Standard Sizes Accommodated	Insulation shapes from 40mm up to 100mm max
Special Cavity Widths Accommodated	Yes – within above range
Straight Reveals	Yes - build in profile as supplied
Checked Reveals	Yes - Turn section 90° & build in as illustrated
Product Lengths	2.1m and 2.4m
Acts as Vertical DPC	Yes
Acts as Insulator	Yes
Permits Different Frame Positions	Yes
Frames Fitted as Work Proceeds or Later	Yes - first or second fix options possible
Timber Frame / Traditional Construction	Both styles accommodated
Masonry Skin Styles	All popular flat faced masonry
Acoustic Insulator	Yes - reduction by sleeved insulation
Fire Rated	No (see Cavi prefixed range for fire rated)
Vertical and Horizontal Applications	Yes – see examples
Compatible with other Cavity Wall Elements	Retro cavity fill could alter insulation sleeve shape
Securing Ties Supplied	Yes
Pack Sizes	x10 lengths
Weight per pack	2.1m x 10 = 13.5kg, 2.4 x 10 = 15 kg
Material	PVCU + siliconised rock wool insulator
Colour	White + green encapsulation sleeve
Building Regulations	Yes regulations can be satisfied
NHBC / Robust Details	Yes requirements can be satisfied
'K' Value of Insulations	0.035W/mK (varies when compressed)
CFC Free	Yes
CAD Drawing Downloads Available	Yes

## QUICKCLOSER

### Vertical closer with flexible insulating core

- Closes the reveal
- Insulates cavities from 40mm to 100mm wide
- Acts as a DPC
- New and existing structure applications
- Integral Fins

**SQUEEZABLE**

- fits into small cavities encountered when altering old properties

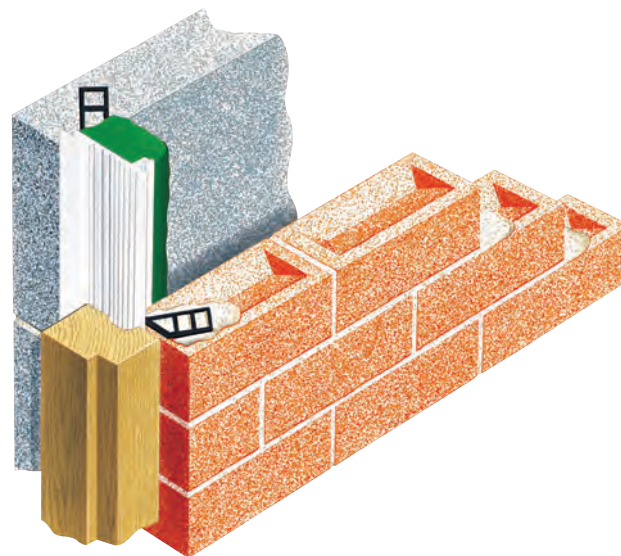

### Requirement

To close, insulate and act as a vertical dpc in reveals with cavities of variable width.

## Solution

The Quickcloser is designed for use in refurbishment, upgrading and alteration works of existing properties constructed prior to 1970, when the traditional cavity width was 2 inches (50mm).

The closer features a flexible insulating core consisting of a polythene sleeve enveloping infill of siliconised rock wool insulation. The sleeve is secured to a rigid face-plate that spans the reveal cavity and overlays both inner and outer masonry skins. The sleeve can be shaped to size by the user, permitting its entry into existing narrow and undulating reveal cavities. Wall ties that accompany this closer may be utilised where the proposed works permit. Alternatively, the face-plate may be directly secured to the masonry skins.

## References

- Building Regulations Part L
- British Standard 5628-3
- BRE Thermal Insulation Avoiding Risks
- Website: [cavitytraystandards.co.uk](http://cavitytraystandards.co.uk)
- Robust Details
- Scottish Tech Standards Part D
- Scottish Tech Standards Part D

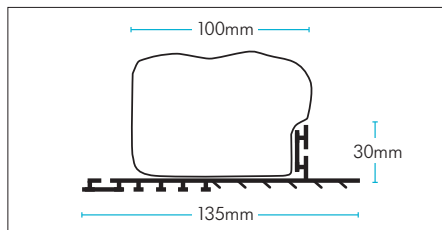

## Refurbishment Applications Type RC Caviclosers

Please note this Quickcloser design can now fulfil all functions of those products and accordingly has superseded them. Existing specifications calling for superseded models will be offered the latest standard.

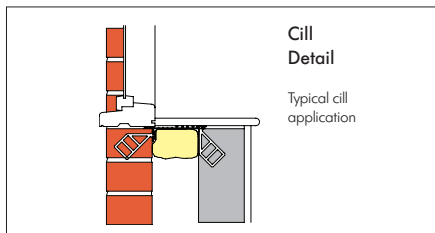
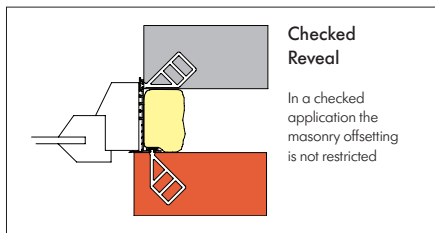
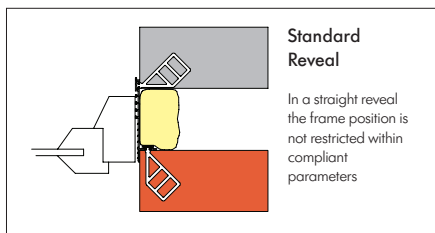

## Designers' Comments

The installer creates the shape of the closing insulation, which can be helpful if the cavity masonry faces are undulating or inconsistent. Thermal performance will vary pending extent of compression within cavity.

## Bill of Quantity / Specification Wording

F30 Accessories / sundry items for brick / block / stone walling

180 Cavity Closers

Manufacturer: Cavity Trays Ltd, Yeovil Somerset BA22 8HU Tel: 01935 474769

Quickcloser to be introduced into cavities exposed during alteration / improvement works to insulate and close at window and door openings. Build in carefully observing manufacturers' instructions to ensure correct installation. (2.1 and 3.0m lengths). Metres run \_\_\_\_\_.



Opening ready to receive 2nd fix Quickcloser